

PJU SBAAN

SIDE NO 271123 BK 4882 PG 0880

Prepared by and return to: William P. Aycock II
Schell Bray Aycock Abel & Livingston P.L.L.C.
P. O. Box 21847, Greensboro, N.C. 27420

NORTH CAROLINA
GUILFORD COUNTY

AMENDMENT TO DECLARATION
OF CONDOMINIUM FOR
INDIGO AT THE LAKE CONDOMINIUM
ADDING PHASE 4, SECTION ONE

10
9

HDS Builders, Inc., a North Carolina corporation with a place of business in Guilford County, North Carolina, hereinafter referred to as "HDS," created and established a Condominium known as "Indigo at the Lake Condominium" (the "Condominium"), by the recordation of a Declaration of Condominium in Book 4408, Page 1718 of the Guilford County Registry (the "Declaration"), and added additional real estate to the Condominium by the recordation of an Amendment to Declaration of Condominium recorded in Book 4450, Page 1755 (the "Phase 2 Amendment") and an Amendment to Declaration of Condominium recorded in Book 4546, Page 0237 (the "Phase 3 Amendment").

Article V(F) of the Declaration provides that in the event a party other than HDS owns any undeveloped portion of the property described in Exhibit "C" of the Declaration and wishes to add such property to the Condominium and to create thereon additional Units, Common Elements and Limited Common Elements, such party shall be entitled to do so and shall, upon recordation of an Amendment to the Declaration adding such additional real property to the Condominium, succeed to all rights of Declarant under the Declaration, the Articles and Bylaws.

D. Stone Builders, Inc., a North Carolina corporation with a place of business in Guilford County, North Carolina, upon recording of an Amendment to Declaration of Condominium recorded in Book 4715, Page 1049 of the Guilford County Registry (the "Phase 5 Amendment"), succeeded to all rights of HDS as Declarant under the Declaration, Articles and Bylaws. Also, upon such recordation, the rights of HDS as Declarant terminated, except such rights as to which HDS is entitled by virtue of its ownership of any Unit. Pursuant to Article V(F) of the Declaration, D. Stone Builders, Inc. shall hereinafter be referred to as "Declarant."

Subsequent to the recordation of the Phase 5 Amendment, Declarant added additional real estate to the Condominium by the recordation in the Guilford County Registry of an Amendment to Declaration of Condominium recorded in Book 4743, Page 1474 (the "Phase 15 and Phase 17 Amendment"), an Amendment to Declaration of Condominium recorded in Book 4787, Page 426 (the "Phase 12 Amendment"), an Amendment to Declaration of Condominium recorded in Book 4819, Page 836 (the "Phase 14 Amendment"), and an Amendment to Declaration of Condominium recorded in Book 4875, Page 1929 (the "Phase 10 Amendment"). The Phase 2 Amendment, Phase 3 Amendment, Phase 5 Amendment, Phase 15 and Phase 17

H:\DOCS\FDD\INDIGO\SEC14.WPD(2/11/99)

08800

North Carolina - Guilford County
The certificate (s) of _____

Mary V. Currie
Noelle B. Breitstein
Patricia A. Sink

A Notary (Notaries) Public is (are) certified to be correct. This instrument and this certificate are duly registered at the date and time shown herein.

KATHERINE LEE PAYNE, REGISTER OF DEEDS
Patricia Summers
Assistant/Deputy Register of Deeds

271123 9

RECORDED
KATHERINE LEE PAYNE
REGISTER OF DEEDS
GUILFORD COUNTY, NC

BOOK: 4882
PAGE(S): 0880 TO 0889

07/02/1999 10:33:45

1 MISC DOCUMENTS \$6.00
9 MISC DOC ADDN PGS \$18.00
1 PROBATE FEE \$2.00

Amendment, Phase 12 Amendment, Phase 14 Amendment, and Phase 10 Amendment shall be referred to collectively herein as the "Prior Amendments."

D. Stone Builders, Inc. is the owner of a portion of the property described in Exhibit "C" of the Declaration and wishes to add such property to the Condominium.

Pursuant to the provisions of Article V(A) and V(F) of the Declaration, Declarant hereby adds additional real estate to the Condominium, and creates upon such additional real estate additional Condominium Units, Common Elements and Limited Common Elements which shall be a part of the Condominium. The additional real estate is located within the land described in Exhibit "C" attached to the Declaration.

Annexed hereto and expressly made a part hereof as Exhibit "A," consisting of two (2) pages, is a survey of the land and graphic descriptions and plans of the additional real estate, Units, Common Elements and Limited Common Elements which are hereby added to and incorporated into the Condominium as Phase 4, Section One, on which property there has been constructed one (1) building on two levels, containing two (2) Condominium Units and their supporting facilities including garages containing four (4) parking spaces, areas designated for four (4) outdoor parking spaces and other appurtenant improvements. The building is of frame construction with brick veneer exterior and vinyl siding and trim.

Certain portions of the Common Elements in Phase 4, Section One, of the Condominium are reserved for the use of a particular Condominium Unit to the exclusion of other Units and are designated as "Limited Common Elements." Limited Common Elements and the Condominium Units to which they are reserved are as follows:

The wood deck to the rear of Units 32 and 33 are allocated exclusively to the respective Unit which provides direct access thereto.

The steps, stoops and porches to the front of Units 32 and 33 are allocated exclusively to the respective Unit which provides direct access thereto.

The Phase 4 Condominium Plan is recorded in Condominium Plat Book 006, Pages 067 and 068 of the Guilford County Public Registry.

Declarant does hereby submit the above described property and improvements to condominium ownership under the provisions of Chapter 47C of the General Statutes of North Carolina (North Carolina Condominium Act), and hereby declares the same to be part of the Condominium.

With the addition to the Condominium of the real estate, Condominium Units, Common Elements and Limited Common Elements shown on Exhibit "A" attached hereto, the Allocated

000881

Interest in the Common Elements appurtenant to all Units in the Condominium have changed, and shall be as set forth in Exhibit "B," which is attached hereto and incorporated herein by reference.

Listed below is the recording data for all easements and licenses which have been recorded subsequent to those listed in Article VII of the Declaration, as updated by the Prior Amendments, and which now affect the Condominium or which now affect any property which may become a part of the Condominium by virtue of the exercise of the Development Rights set out in Article V of the Declaration:

1. Easements for ingress, regress and egress reserved by LSOF Partners X, L.P. in deed to D. Stone Builders, Inc., recorded in Book 4603, Page 1053 of the Guilford County Registry;
2. Easements granted in a Deed of Trust from D. Stone Builders, Inc. to TIM, Inc., Trustee, and NationsBank, National Association, recorded in Book 4603, Page 1056 of the Guilford County Registry; and
3. Easements shown on the Phase 4 Condominium Plan.

Except as specifically amended by the Prior Amendments and as specifically amended herein, the Declaration of Condominium for Indigo at the Lake Condominium shall remain in full force and effect.

IN WITNESS WHEREOF, D. Stone Builders, Inc. has caused these presents to be duly executed in its name and its corporate seal hereunto affixed, all as of the 24 day of June, 1999.

D. STONE BUILDERS, INC.

By: [Signature]
President

ATTEST:

[Signature]
Secretary
(CORPORATE SEAL)



000882

NORTH CAROLINA

Guilford COUNTY

I, Mary V. Currie, a Notary Public of the County and State aforesaid, certify that John Charles Upchurch personally appeared before me this day and acknowledged that he is the _____ Secretary of D. STONE BUILDERS, INC., a North Carolina corporation, and that by authority duly given and as the act of the corporation, the foregoing instrument was signed in its name by its _____ President, sealed with its corporate seal and attested by John Charles Upchurch as its _____ Secretary.

Witness my hand and official stamp or seal, this 25 day of June, 1999.

Mary V. Currie
Notary Public

My commission expires:
2-5-2002
(Stamp/Seal)

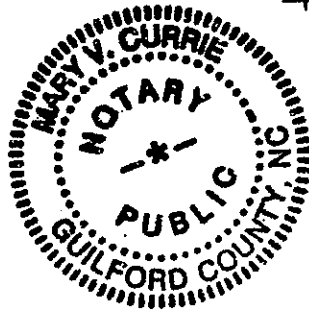

500883

LSOF Partners X, L.P., a Texas limited partnership and successor to Cornwallis Development Co., through execution by its Attorney-In-Fact, evidences its consent to the recording of this Amendment to Declaration of Condominium, pursuant to the provisions of Paragraph 1(C) of the Warranty Deed from LSOF Partners X, L.P. to D. Stone Builders, Inc., which Warranty Deed is recorded in Book 4603, Page 1053, of the Guilford County Registry.

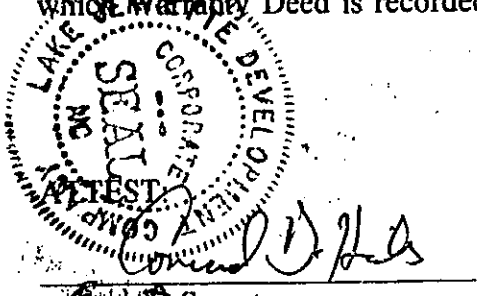

Conrad D. Hicks
Secretary
(CORPORATE SEAL)

LSOF Partners X, L.P.,
a Texas limited partnership (SEAL)

By: LAKE JEANETTE DEVELOPMENT
COMPANY, a Texas corporation,
Attorney-In-Fact

By: [Signature]
President

STATE OF North Carolina
COUNTY OF Guilford

I, Noelle B. Breitenstein, a Notary Public, do hereby certify that Conrad D. Hicks personally appeared before me this day and acknowledged that he/she is the Asst. Secretary of LAKE JEANETTE DEVELOPMENT COMPANY, a Texas corporation qualified to do business in North Carolina, that the seal affixed to the foregoing instrument in writing is the corporate seal of the corporation, that said writing was signed by its President, attested to and sealed by him/her as its Asst. Secretary on behalf of LSOF PARTNERS X, L.P., a Texas limited partnership, by its authority duly given, and that said writing is the act and deed of said corporation as Attorney-In-Fact for LSOF PARTNERS X, L.P., and that its authority to execute and acknowledge said instrument is contained in an instrument duly executed, acknowledged and recorded in the Office of the Register of Deeds of Guilford County, North Carolina, on May 8, 1997, in Book 4536, Page 1117; that this instrument was executed under and by virtue of the authority given by said instrument granting it power of attorney; that the said Attorney-In-Fact acknowledged the due execution of the foregoing and annexed instrument for the purposes therein expressed for and in behalf of said LSOF PARTNERS X, L.P., and that said writing is the act and deed of said limited partnership and said corporation as its Attorney-In-Fact.

WITNESS my hand and official seal this the 24th day of June, 1999

Noelle B. Breitenstein
Notary Public

My commission expires:
9-14-99

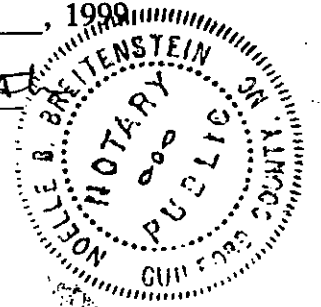

000884

NationsBank, National Association, as holder of a promissory note secured by a deed of trust on the property described in this Amendment to Declaration of Condominium, said deed of trust being recorded in Book 4603, Page 1056, Guilford County Registry, and TIM, Inc., as Trustee under said deed of trust, join in the execution hereof for the purpose of subjecting the aforesaid deed of trust to the terms and provisions of the Declaration of Condominium.

NATIONSBANK, NATIONAL ASSOCIATION

By: Charles E. Egan
Vice President

ATTEST:

Michael C. Davis
Secretary
(CORPORATE SEAL)
NATIONS BANK NATIONAL ASSOCIATION
*
NORTH CAROLINA

TIM, INC., TRUSTEE

By: Charles E. Egan
Vice President

ATTEST:

Michael C. Davis
Secretary

(CORPORATE SEAL)
TIM, INC.
CORPORATE SEAL
NORTH CAROLINA

600885

NORTH CAROLINA

Guilford COUNTY

I, Patricia A. Sink, a Notary Public, do hereby certify that Michelle C. Davis personally appeared before me this day and acknowledged that he/she is the Asst. Secretary of NATIONSBANK, NATIONAL ASSOCIATION and that by authority duly given and as the act of the corporation, the foregoing instrument was signed in its name by its Vice President, sealed with its corporate seal, and attested by himself/herself as its Asst. Secretary.

Witness my hand and official stamp or seal, this 27th day of JUNE, 1999.

Patricia A. Sink
Notary Public

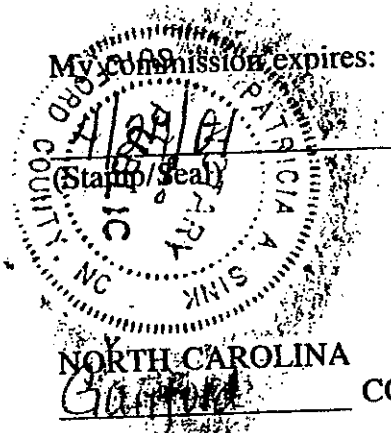

00886

I, Patricia A. Sink, a Notary Public, do hereby certify that Michelle C. Davis personally appeared before me this day and acknowledged that he/she is the Asst. Secretary of TIM, INC., Trustee, and that by authority duly given and as the act of the corporation, the foregoing instrument was signed in its name by its Vice President, sealed with its corporate seal, and attested by himself/herself as its Asst. Secretary

Witness my hand and official stamp or seal, this 29th day of June, 1999.

Patricia A. Sink
Notary Public

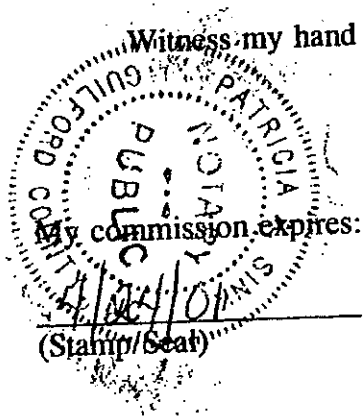

This map is not a certified survey and has not been reviewed by a local governmental agency for compliance with any applicable land development regulations. The original plat of which this map is a reduced copy has been reviewed by The City of Greensboro Planning Department and is being recorded simultaneously with the Amendment to Declaration to which this map is attached.

00888

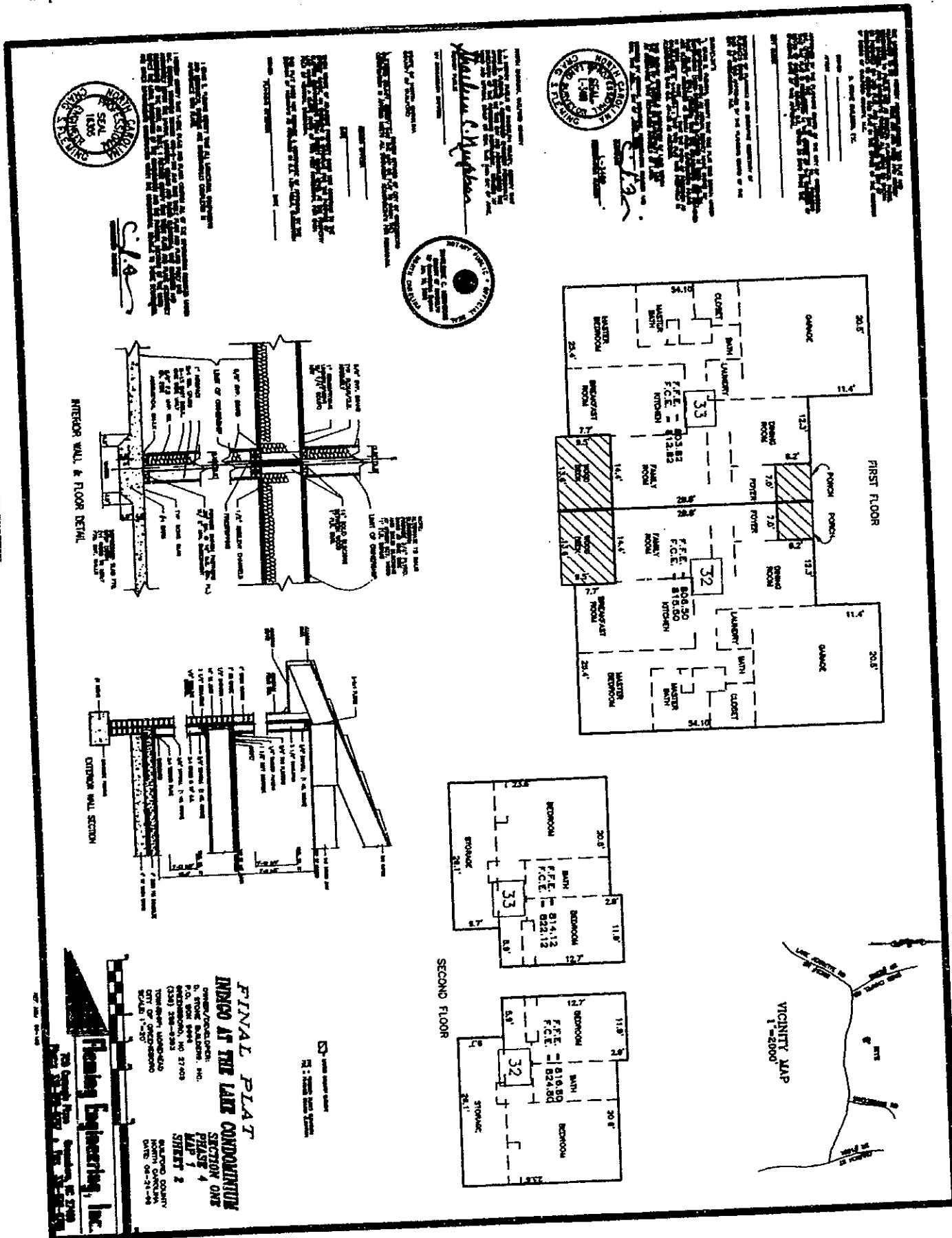

NOTICE TO CONTRACTOR
THIS SET OF ARCHITECTURAL DRAWINGS IS THE PROPERTY OF THE ARCHITECT AND IS TO BE USED ONLY FOR THE PROJECT AND SITE SPECIFICALLY IDENTIFIED HEREON. IT IS NOT TO BE REPRODUCED, COPIED, REPRODUCED, OR TRANSMITTED IN ANY FORM OR BY ANY MEANS, ELECTRONIC OR MECHANICAL, INCLUDING PHOTOCOPYING, RECORDING, OR BY ANY INFORMATION STORAGE AND RETRIEVAL SYSTEM, WITHOUT THE WRITTEN PERMISSION OF THE ARCHITECT.

NOTICE TO CONTRACTOR
THIS SET OF ARCHITECTURAL DRAWINGS IS THE PROPERTY OF THE ARCHITECT AND IS TO BE USED ONLY FOR THE PROJECT AND SITE SPECIFICALLY IDENTIFIED HEREON. IT IS NOT TO BE REPRODUCED, COPIED, REPRODUCED, OR TRANSMITTED IN ANY FORM OR BY ANY MEANS, ELECTRONIC OR MECHANICAL, INCLUDING PHOTOCOPYING, RECORDING, OR BY ANY INFORMATION STORAGE AND RETRIEVAL SYSTEM, WITHOUT THE WRITTEN PERMISSION OF THE ARCHITECT.

NOTICE TO CONTRACTOR
THIS SET OF ARCHITECTURAL DRAWINGS IS THE PROPERTY OF THE ARCHITECT AND IS TO BE USED ONLY FOR THE PROJECT AND SITE SPECIFICALLY IDENTIFIED HEREON. IT IS NOT TO BE REPRODUCED, COPIED, REPRODUCED, OR TRANSMITTED IN ANY FORM OR BY ANY MEANS, ELECTRONIC OR MECHANICAL, INCLUDING PHOTOCOPYING, RECORDING, OR BY ANY INFORMATION STORAGE AND RETRIEVAL SYSTEM, WITHOUT THE WRITTEN PERMISSION OF THE ARCHITECT.

NOTICE TO CONTRACTOR
THIS SET OF ARCHITECTURAL DRAWINGS IS THE PROPERTY OF THE ARCHITECT AND IS TO BE USED ONLY FOR THE PROJECT AND SITE SPECIFICALLY IDENTIFIED HEREON. IT IS NOT TO BE REPRODUCED, COPIED, REPRODUCED, OR TRANSMITTED IN ANY FORM OR BY ANY MEANS, ELECTRONIC OR MECHANICAL, INCLUDING PHOTOCOPYING, RECORDING, OR BY ANY INFORMATION STORAGE AND RETRIEVAL SYSTEM, WITHOUT THE WRITTEN PERMISSION OF THE ARCHITECT.

NOTICE TO CONTRACTOR
THIS SET OF ARCHITECTURAL DRAWINGS IS THE PROPERTY OF THE ARCHITECT AND IS TO BE USED ONLY FOR THE PROJECT AND SITE SPECIFICALLY IDENTIFIED HEREON. IT IS NOT TO BE REPRODUCED, COPIED, REPRODUCED, OR TRANSMITTED IN ANY FORM OR BY ANY MEANS, ELECTRONIC OR MECHANICAL, INCLUDING PHOTOCOPYING, RECORDING, OR BY ANY INFORMATION STORAGE AND RETRIEVAL SYSTEM, WITHOUT THE WRITTEN PERMISSION OF THE ARCHITECT.

NOTICE TO CONTRACTOR
THIS SET OF ARCHITECTURAL DRAWINGS IS THE PROPERTY OF THE ARCHITECT AND IS TO BE USED ONLY FOR THE PROJECT AND SITE SPECIFICALLY IDENTIFIED HEREON. IT IS NOT TO BE REPRODUCED, COPIED, REPRODUCED, OR TRANSMITTED IN ANY FORM OR BY ANY MEANS, ELECTRONIC OR MECHANICAL, INCLUDING PHOTOCOPYING, RECORDING, OR BY ANY INFORMATION STORAGE AND RETRIEVAL SYSTEM, WITHOUT THE WRITTEN PERMISSION OF THE ARCHITECT.

NOTICE TO CONTRACTOR
THIS SET OF ARCHITECTURAL DRAWINGS IS THE PROPERTY OF THE ARCHITECT AND IS TO BE USED ONLY FOR THE PROJECT AND SITE SPECIFICALLY IDENTIFIED HEREON. IT IS NOT TO BE REPRODUCED, COPIED, REPRODUCED, OR TRANSMITTED IN ANY FORM OR BY ANY MEANS, ELECTRONIC OR MECHANICAL, INCLUDING PHOTOCOPYING, RECORDING, OR BY ANY INFORMATION STORAGE AND RETRIEVAL SYSTEM, WITHOUT THE WRITTEN PERMISSION OF THE ARCHITECT.

NOTICE TO CONTRACTOR
THIS SET OF ARCHITECTURAL DRAWINGS IS THE PROPERTY OF THE ARCHITECT AND IS TO BE USED ONLY FOR THE PROJECT AND SITE SPECIFICALLY IDENTIFIED HEREON. IT IS NOT TO BE REPRODUCED, COPIED, REPRODUCED, OR TRANSMITTED IN ANY FORM OR BY ANY MEANS, ELECTRONIC OR MECHANICAL, INCLUDING PHOTOCOPYING, RECORDING, OR BY ANY INFORMATION STORAGE AND RETRIEVAL SYSTEM, WITHOUT THE WRITTEN PERMISSION OF THE ARCHITECT.

FINAL PLAT
RINCO AT THE LAKE CONDOMINIUM
SECTION ONE
PLEASE SEE MAP 1
STREET 2
SALVING COMPANY
DATE: 08-21-98

Planning Engineering, Inc.
200 South Main Street, Greensboro, NC 27401
Phone: 336-333-1111
Fax: 336-333-1112

CONDOMINIUM PLAT BOOK *D16* PAGE *068*

Indigo at the Lake Condominium
 Amendment to Declaration of Condominium
 Exhibit "B"
 Phases 1, 2, 3, 5, 15, 17, 12, 14, 10, 16 and 4, Section One

<u>Unit Number</u>	<u>Allocated Interest in Common Elements</u>
1	2.1645%
2	2.1645%
3	2.5974%
4	2.1645%
5	2.1645%
6	2.5974%
7	2.4892%
8	2.5974%
9	2.1645%
10	2.1645%
11	2.5974%
12	2.1645%
13	2.1645%
14	2.5974%
15	2.1645%
16	2.1645%
17	2.5974%
18	2.1645%
19	2.5974%
20	2.4892%
21	2.5974%
22	2.1645%
23	2.1645%
24	2.5974%
25	2.1645%
26	2.4892%
27	2.5974%
28	2.4892%
29	2.5974%
30	2.5974%
31	2.5974%
32	2.5974%
33	2.5974%
42	2.5974%
43	2.5974%
46	2.5974%
47	2.5974%
50	2.5974%
51	2.5974%
52	2.5974%
53	<u>2.5974%</u>
	100.0000%

688009889